

# 1 / NOMENCLATURE

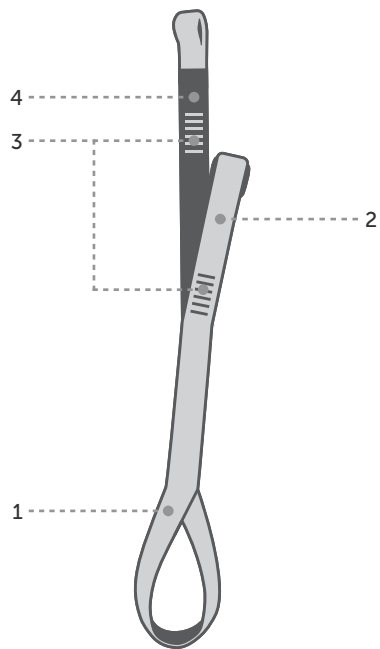

1. Harness attachment loop | 2. Short arm  
3. Bar tack (3) | 4. Long arm

# 2 / COMPATIBILITY

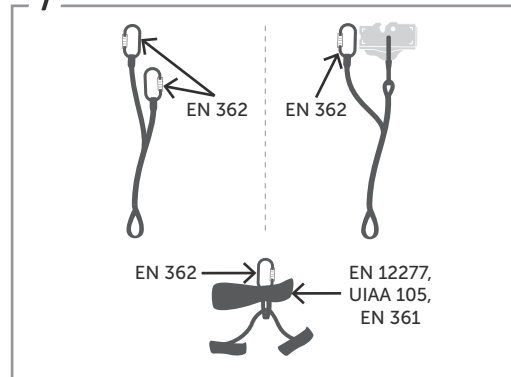

# 3 / USAGE

## a. Connecting

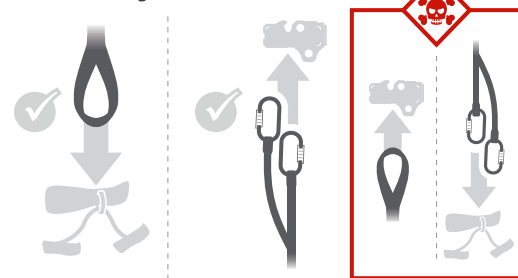

## b. Harness Installation

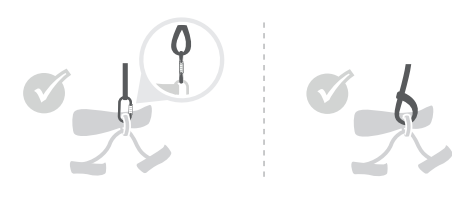

## c. Trolley Installation

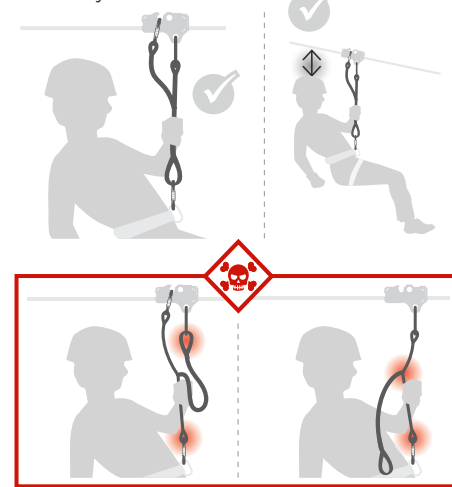

## 1. NOMENCLATURE

1. Harness attachment loop | 2. Short arm | 3. Bar tack (3) | 4. Long arm

## 2. COMPATIBILITY

Verify that this product is compatible with the other elements of the system. Equipment used with this lanyard must meet current local, state, or country standards. Danger may arise when using a combination of items and equipment in which the safe function of any one item is adversely affected by or interferes with the safe function of another. Always use locking connectors. When using this lanyard with the LightSpeed EZ Clip Trolley, the short arm should be connected directly to the EZ Clip's attachment link as shown.

## 3. USAGE

3a. Connecting: The harness attachment loop must be connected to the harness only. The long and short arms of the lanyard must be connected to anchor points only. | 3b. Harness Installation: Attach the harness attachment loop to the harness using a locking EN 362 carabiner or a choke hitch as shown. | 3c. Trolley Installation: Attach the short arm of the lanyard to the primary connection on the trolley. Attach the long arm of the lanyard to the backup connection as shown. Primary and secondary carabiners should be installed with locking gates opposite and opposed. Ensure that lanyard length is compatible with all elements of your zipline. | 3d. Usage with an Energy Absorber: Connect one end of the energy absorber to the harness and the opposite end to the harness attachment loop of the lanyard via a choke hitch or EN 362 carabiner. The total length of a lanyard connected to an energy absorber (including terminations and connectors) shall not exceed 2.0 m (6.6 ft). The lanyard is intended for static use only and shall not be used as part of a fall arrest system. This lanyard is rated to absorb falls of less than 0.6 m (2 ft). | 3e. Precautions: Prior to use, if you think there is a risk of the lanyard coming into contact with a sharp edge, take appropriate precautions. The user should minimize the amount of slack in the lanyard near a fall hazard. Do not shock load the lanyard. Users must be medically fit for activities at height. Inert suspension in a

harness can result in serious injury or death. A rescue plan must be in place to deal with emergency situations that might arise during the use of this product.

## 4. SPECIFICATIONS & ADDITIONAL INFORMATION

4a. Load Limits: Minimum Breaking Strength of 22.2 kN | 4b. Lifespan: 10 years after the Date of Manufacture as marked on the product tag. This product must be retired for any of the following conditions: it has been subjected to a major fall or loading event; if it is over 10 years old; it fails to pass inspection; there is any doubt as to its reliability; you do not know its full usage history; when it becomes obsolete due to changes in legislation or standards. When retiring, destroy the product to prevent further use. | 4c. Working Temperature | 4d. Storage: Store the lanyard in a dry area where it is protected from UV light, chemicals, or any other extreme conditions. | 4e. Cleaning: Clean only using mild soap or detergent and water. | 4f. Drying: Allow the lanyard to air dry. | 4g. Maintenance: Do not apply oil, grease, solvents, etc. | 4h. Inspection: Before each use, visually inspect the full length of the lanyard and ensure the lanyard is properly attached to the correct points on all equipment. Check that there are no broken stitches in the bar tack. The lanyard should be retired immediately if any doubt arises about its condition for safe use or if it shows any of the following: cuts, burns, frayed strands, fuzzy/abraded areas, signs of chemical contamination. Icy or wet webbing is weaker and less abrasion resistant. | 4i. Repairs: No modifications or repairs shall be made to this product.

In the event that this product is resold outside of the original country of destination it is imperative for the safety of the user that the instructions for use, maintenance, and inspection are provided in the language of the country the product is to be used.

## 5. MARKINGS

1. Minimum Breaking Strength | 2. Connecting | 3. Date of Manufacture | 4. Lanyard Length | 5. Read Instructions | 6. Standard | 7. Manufacturer

## 5 / TRACEABILITY & MARKINGS

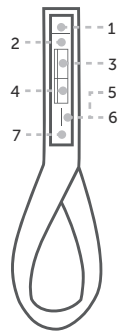

1. Minimum Breaking Strength
2. Connecting
3. Date of Manufacture
4. Lanyard Length
5. Read Instructions
6. Standard
7. Manufacturer

visit [headrushtech.com](http://headrushtech.com)



latest version



other languages



more information

### ADDRESS

Head Rush Technologies  
1699 Cherry St, Suite C  
Louisville, CO 80027 USA

### CONTACT DETAILS

+1-720-565-6885  
[www.headrushtech.com](http://www.headrushtech.com)  
[info@headrushtech.com](mailto:info@headrushtech.com)

EN 354:2010

## 3 / USAGE (continued)

### d. Usage with an Energy Absorber

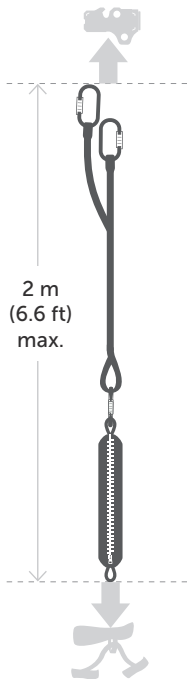

### e. Precautions

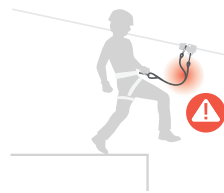
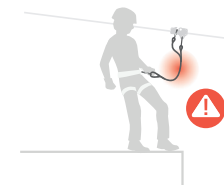
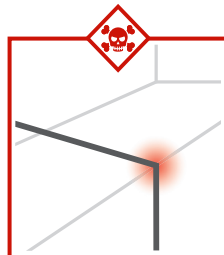

## 4 / SPECIFICATIONS & ADDITIONAL INFO

### a. Load Limits



### b. Lifespan



### c. Working Temperature



-40°C / -40°F  
80°C / 176°F

### d. Storage



### e. Cleaning



### f. Drying



### g. Maintenance



### h. Inspection



### i. Repairs



Head Rush Technologies

# LIGHTSPEED ZIP LINE LANYARD

OPERATOR & INSTALLER MANUAL

Models: 12 in (30.5 cm), 16 in (40.6 cm), 24 in (61 cm), and 36 in (91.4 cm)



**ALWAYS READ INSTRUCTIONS BEFORE USE.** This product is intended for use on zip lines. Zip lining is a dangerous activity. Before using this product, you must read and understand the instructions herein and accept the risks involved.

**Failure by the installer, operator, or user to heed any and all instructions, warnings, and cautions for the correct installation, operation, care and maintenance of the LightSpeed Lanyard may result in serious injury or death.**

This document may only be removed by the end user.